



# SHOP DRAWINGS FOR: Project Example 2

KAYSVILLE, UT 84037

Hobbs Building Systems, LLC  
3311 100th Street, #3537  
Urbandale, IA 50323  
Phone: 515.473.9255  
Fax: 515.974.4399  
Email: info@hobbsbuildingsystems.com  
Website: www.hobbsverticalicf.com

Sheet List	
Sheet Number	Sheet Name
1	COVER SHEET
2	PROJECT INFO
3	LAYOUT PLAN
4	LAYOUT PLAN
5	WALL SECTIONS
6	DETAILS
7	DETAILS
8	DETAILS
9	HORIZ. REINF.

**PATENTS:**

U.S.: #8,371,082  
CANADA: #2,621,024

All drawings and details shall be constructed in accordance with the local building code regulations, project engineering, and construction practices. Design contained herein are protected by copyright, recipient acknowledges contents are property of Hobbs Building Systems, LLC., and shall be used only for construction purposes and not copied, used or reproduced, for any other purposes or projects without written permission from Hobbs Building Systems, LLC. all rights reserved. Hobbs Building Systems, LLC. 2015. Hobbs Building Systems, LLC reserves the right to make changes to the drawings/information shown without notice.

**ABBREVIATIONS**

- |                       |   |
|-----------------------|---|
| ARCH. = ARCHITECTURAL | MIN. = MINIMUM                          |
| BM. = BEAM            | O.C. = ON CENTER                        |
| BTM. = BOTTOM         | PL. = PLATE                             |
| CONT. = CONTINUOUS    | PSF = LBS PER SQUARE FOOT               |
| CTR. = CENTER         | REINF. = REINFORCING                    |
| DWL. = DOWEL          | R.O. = ROUGH OPENING                    |
| EA. = EACH            | S.R. = STUCCO READY                     |
| ELEV. = ELEVATION     | T.O.W. = TOP OF WALL                    |
| E.O. = EVERY OTHER    | TYP. = TYPICAL                          |
| E.S. = EXPOSED STUD   | VERT. = VERTICAL                        |
| FLR. = FLOOR          | VICF = VERTICAL INSULATED CONCRETE FORM |
| FTG. = FOOTING        | W/ = WITH                               |
| G-V = GABLE - VARIES  | W.H. = WALL HEIGHT                      |
| HORIZ. = HORIZONTAL   |   |

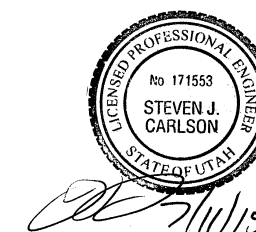

KAYSVILLE, UT 84037

JOB # 182099

- NOT FOR CONSTRUCTION  
 FOR CONSTRUCTION

ISSUE DATE :  
080818

- REVISIONS:
- |   |   |    |
|---|---|----|
| 1 | - | 6  |
| 2 |   | 7  |
| 3 |   | 8  |
| 4 |   | 9  |
| 5 |   | 10 |

DRAWING SCALE :  
12" = 1'-0"

DRAWING NAME :  
COVER SHEET

LINTEL SCHEDULE					
MARK	LINTEL BAR	SHEAR REINFORCING	HEAD R.O.	LINTIL DEPTH	WIDTH R.O.
L1	#5 (R.O. + 1'-0")	#3 STIRRUP W/ 2 1/2" HOOK EA. END @ 12" O.C.	VERIFY	1'-0" MIN.	3'-0" & BELOW
L2	#5 (R.O. + 1'-0")	#3 STIRRUP W/ 2 1/2" HOOK EA. END @ 12" O.C.	VERIFY	1'-0" MIN.	4'-0"
L3	#5 (R.O. + 1'-0")	#3 STIRRUP W/ 2 1/2" HOOK EA. END @ 12" O.C.	VERIFY	1'-0" MIN.	5'-0"
L4	#5 (R.O. + 1'-0")	#3 STIRRUP W/ 2 1/2" HOOK EA. END @ 12" O.C.	VERIFY	1'-0" MIN.	6'-0"
L5	#5 (R.O. + 1'-0")	#3 STIRRUP W/ 2 1/2" HOOK EA. END @ 12" O.C.	VERIFY	1'-0" MIN.	7'-6"
L6	#5 (R.O. + 1'-0")	#3 STIRRUP W/ 2 1/2" HOOK EA. END @ 12" O.C.	VERIFY	1'-0" MIN.	1'-5"

### WALL HORIZ. REINFORCING SCHEDULE

WALL HT.	TOP OF WALL BAR	INTERMEDIATES	BOTTOM OF WALL BAR
9'-0"	#4	#4 @ 18" O.C.	#4
10'-0"	#4	#4 @ 18" O.C.	#4
12'-0"	#4	#4 @ 18" O.C.	#4

### BASEMENT WALL VERT. REINFORCING SCHEDULE

LOCATION	WALL HT.	VERT. REINF. BAR	SPACING	POSITION
BASEMENT WALLS	10'-0"	#6	16" O.C.	OFFSET

### MAIN FLOOR WALL VERT. REINFORCING SCHEDULE

LOCATION	WALL HT.	VERT. REINF. BAR	SPACING	POSITION
TYP. MAIN FLR. WALLS	9'-0"	#4	24" O.C.	CENTER
RAISED PLATE WALLS	12'-0"	#4	16" O.C.	CENTER

### DOWEL REINFORCING SCHEDULE

LOCATION	VERT. REINF. BAR	SPACING	EMBED	PROJECTION	POSITION
@ FOOTING	#5	48" O.C.	6"	6"	CENTER
@ 1ST/2ND FLR. JT.	#5	48" O.C.	6"	6"	CENTER

#### DOWEL NOTES:

- ALL DOWELS TO START 12" IN FROM OUTSIDE OF FORM CORNER
- DOWELS NOT TO EXCEED SPECIFIED SPACING PER SCHEDULE
- DOWEL SPACINGS NOT REQUIRED TO ALIGN WITH VERT. BARS

## GENERAL NOTES / DESIGN DATA

#### DESIGN PARAMETERS:

- BUILDING CODE REFERENCE  
INTERNATIONAL RESIDENTIAL CODE 2015  
2011 EDITION ACI 318

- LOADS

#### 2.1. DEAD LOADS

ROOF: 20 PSF  
ICF WALLS: 75 PSF  
FLOORS: 20 PSF  
WOOD STUD WALLS: 15 PSF  
DECK: 10 PSF

#### 2.2. LIVE LOADS

ROOF: 20 PSF (SNOW)  
FLOORS: 40 PSF

#### 2.3. WIND

V = 115 MPH, EXP. C, I = 1.0

2.4 LATERAL EARTH PRESSURE ON FOUNDATION WALLS: 45 PSF/FT

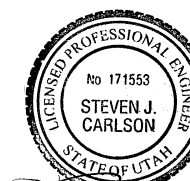

*Signature* 7/11/19

#### CONSTRUCTION MATERIAL:

- CONCRETE:

MINIMUM COMPRESSIVE DESIGN STRENGTH AT 28 DAYS OF 4,000 PSI, MAXIMUM WATER-TO-CEMENT RATIO, W / CM = 0.43. 3/8" LIMESTONE CHIPS OR 3/8" WASHED RIVER ROCK AGGREGATE, 4" TO 5" SLUMP. CAN SUBSTITUTE 15% CLASS C FLYASH BY WEIGHT FOR CEMENT IN CONCRETE MIX

- REINFORCEMENT:

ASTM A615 GRADE 60.

#### GENERAL NOTES:

GENERAL CONTRACTOR SHALL BE RESPONSIBLE FOR COORDINATION OF DETAILS PROVIDED FOR HOBBS WALL SYSTEM WITH FOUNDATIONS, FLOOR & ROOF FRAMING. THIS DRAWING SET IS NOT MEANT TO BE DEFINITIVE FOR BUILDING DIMENSIONS & LAYOUT. ICF WALL INSTALLATION SHOULD BE COORDINATED WITH OTHER TRADES & BUILDING DIMENSIONS & LAYOUT CONFIRMED WITH THE APPROPRIATE PARTIES.

EARTH BACKFILL AGAINST BASEMENT WALLS SHALL BE OF TYPE (ACCORDING TO THE UNIFIED SOIL CLASSIFICATION SYSTEM) GW, GP, SW, SP, GM, GC, SM, SM-SC, OR ML, AND SHALL BE TILED AT FOOTING ELEVATION

KAYSVILLE, UT 84037

JOB # : 182099

NOT FOR CONSTRUCTION

FOR CONSTRUCTION

ISSUE DATE :

080818

REVISIONS:

1	-	6
2		7
3		8
4		9
5		10

DRAWING SCALE :



12" = 1'-0"

DRAWING NAME :

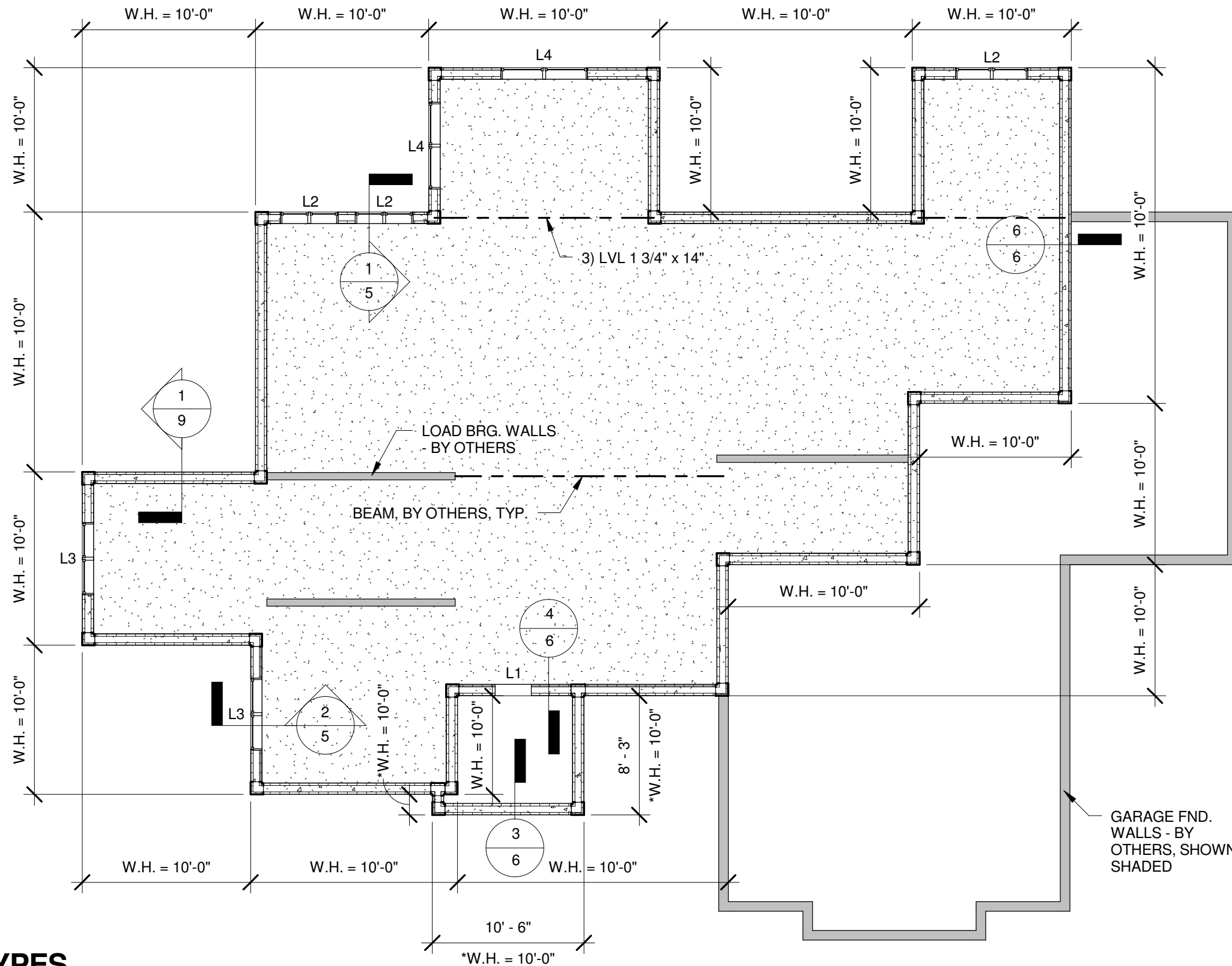
PROJECT INFO



**WALL TYPES**

-  EXT. CONTOUR WALL - EXPOSED STUD
-  EXT. FLAT WALL - EXPOSED STUD

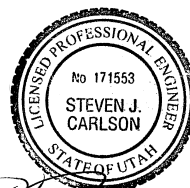

- NOTES:
- BUILDING DIMENSIONS FOR REFERENCE ONLY - SEE ARCHITECTURAL PLANS FOR ALL DIMENSIONS - ARCHITECTURAL PLANS TO TAKE PRESEDENCE
  - PROVIDE FOOTING DRAINAGE PER DETAIL DRAIN TILE TO BE PROVIDED BY OTHERS - TO BE INSTALLED PER CODE. 3 / 5
- \* CUT DOWN BOTTOM OF PANELS TO ADJUST FOR DESIRED HEIGHT OF STOOP WALLS.

2 BASEMENT  
1/8" = 1'-0"

KAYSVILLE, UT 84037

JOB # : 182099

- NOT FOR CONSTRUCTION
- FOR CONSTRUCTION

ISSUE DATE :  
080818

REVISIONS:

1	6
2	7
3	8
4	9
5	10

DRAWING SCALE :

1/8" = 1'-0"

DRAWING NAME :

LAYOUT PLAN

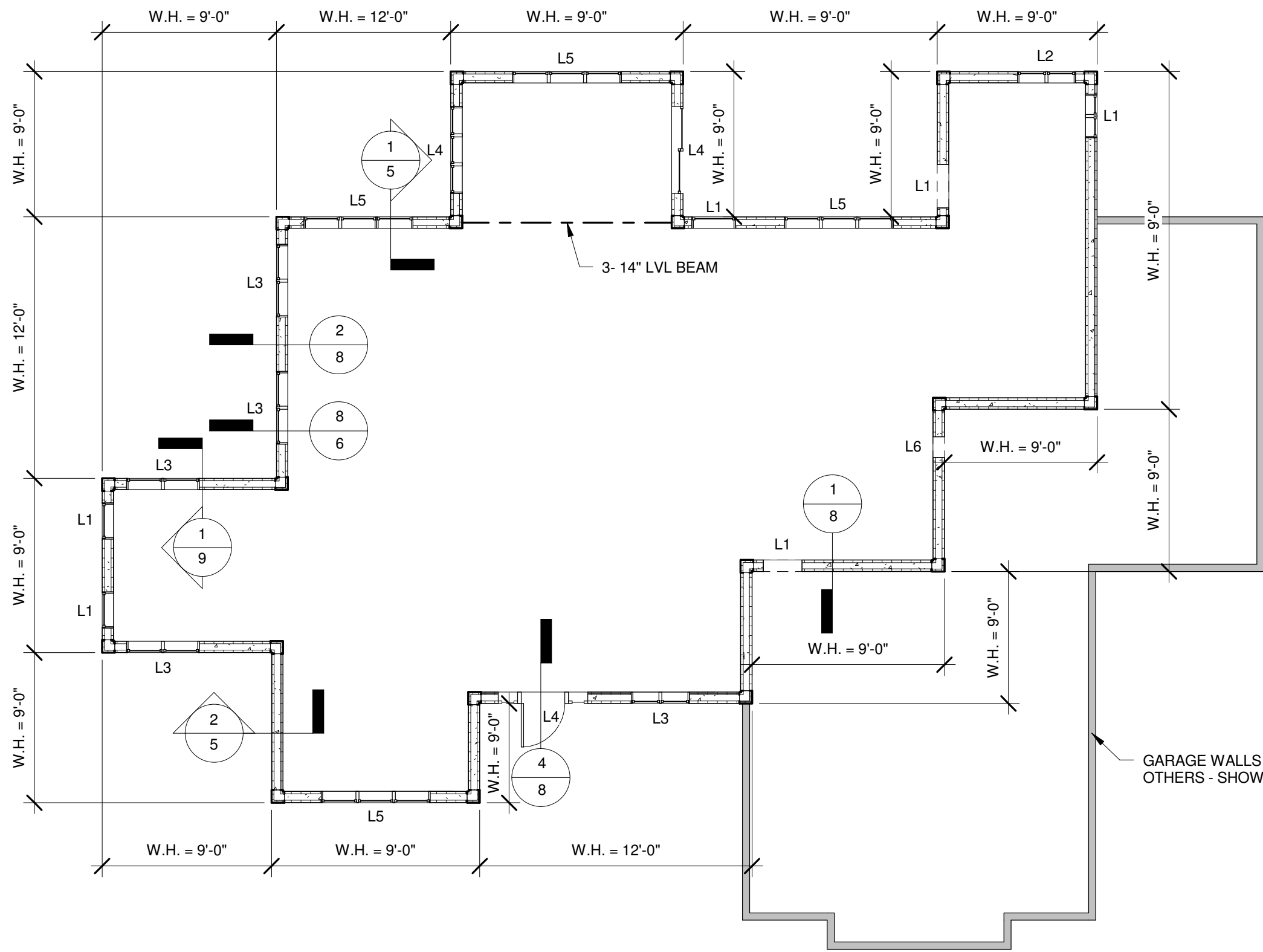

**WALL TYPES**

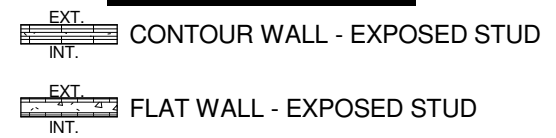

KAYSVILLE, UT 84037  
JOB #: 182099

- NOT FOR CONSTRUCTION
- FOR CONSTRUCTION

ISSUE DATE :  
080818

REVISIONS:

△ 1	-	△ 6
△ 2		△ 7
△ 3		△ 8
△ 4		△ 9
△ 5		△ 10

DRAWING SCALE :  
1/8" = 1'-0"

DRAWING NAME :  
LAYOUT PLAN

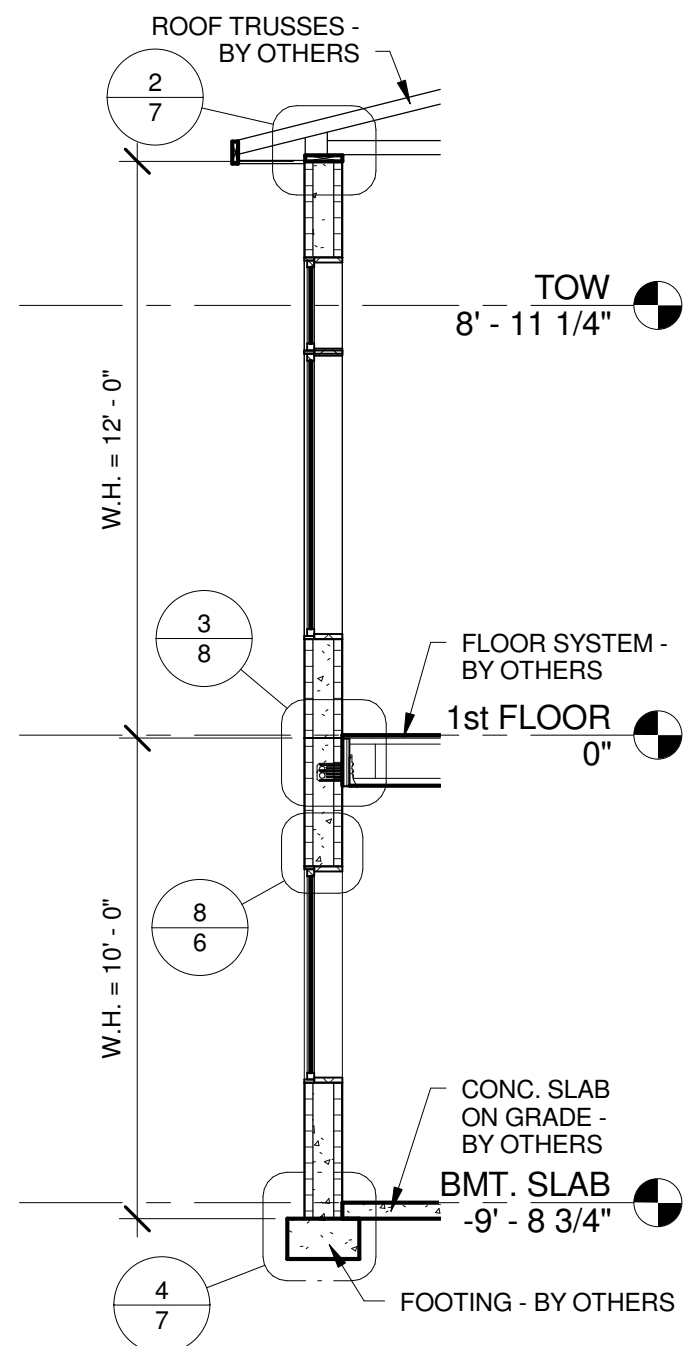

1 WALL SECTION @ RAISED PLT.  
1/4" = 1'-0"

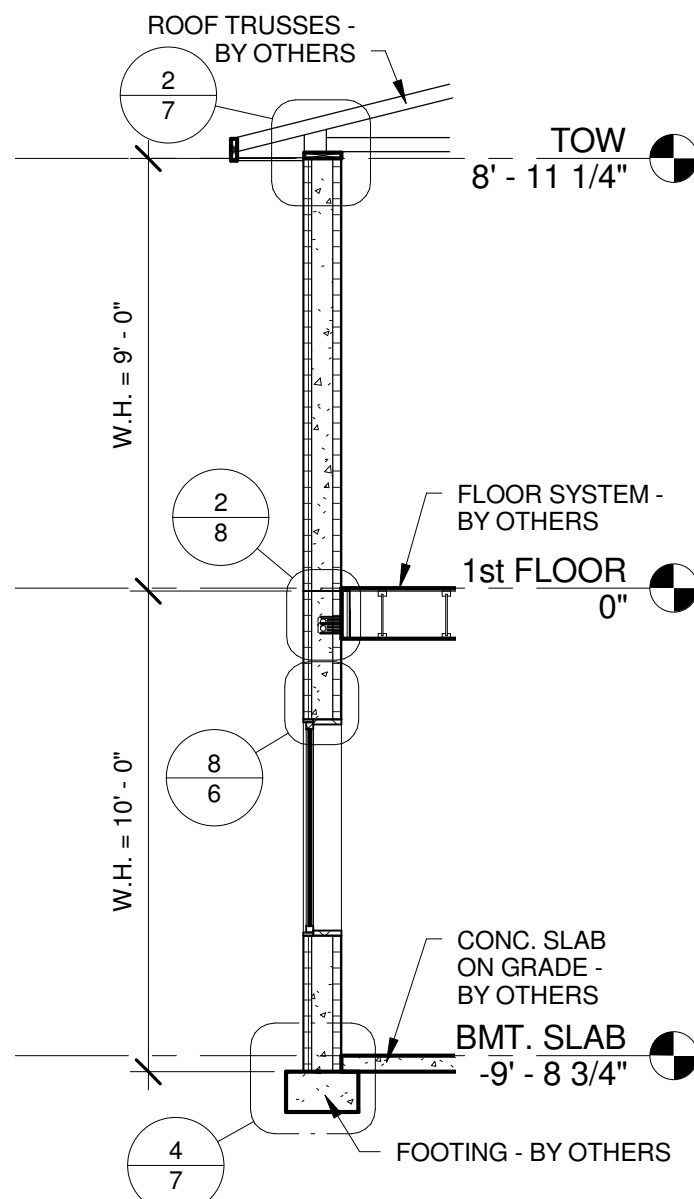

2 TYP. WALL SECTION  
1/4" = 1'-0"

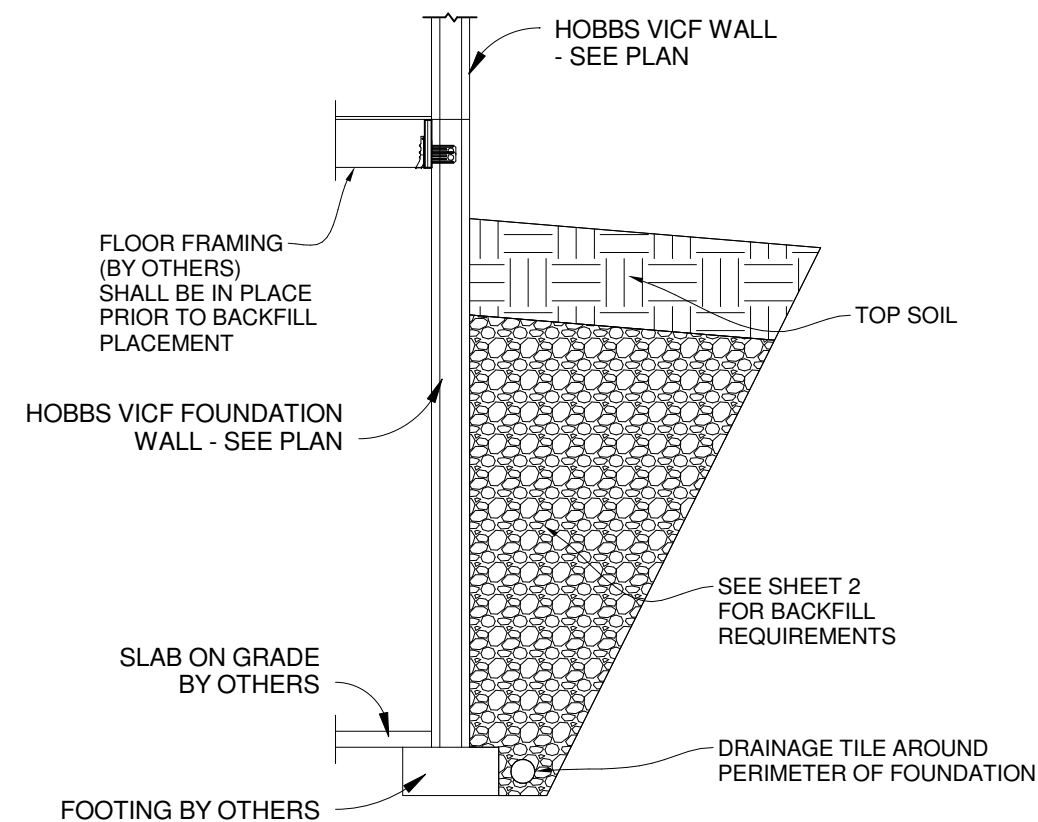

3 TYP. BASEMENT WALL SECTION  
1/4" = 1'-0"

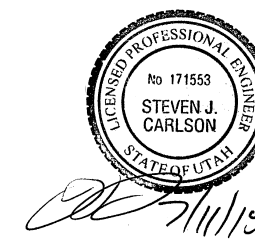

KAYSVILLE, UT 84037

JOB #: 182099

NOT FOR CONSTRUCTION

FOR CONSTRUCTION

ISSUE DATE :

080818

REVISIONS:

1	6
2	7
3	8
4	9
5	10

DRAWING SCALE :

1/4" = 1'-0"

DRAWING NAME :

WALL SECTIONS

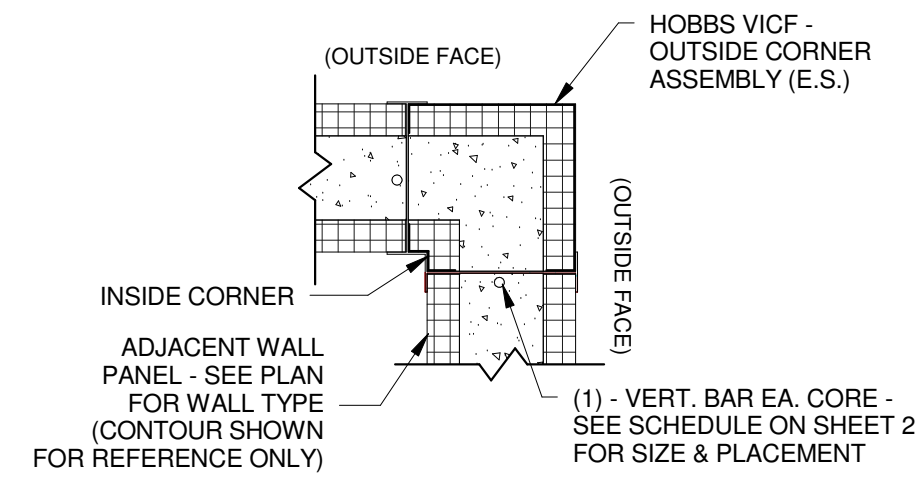

1 CORNER - EXPOSED STUD (E.S.)  
1" = 1'-0"

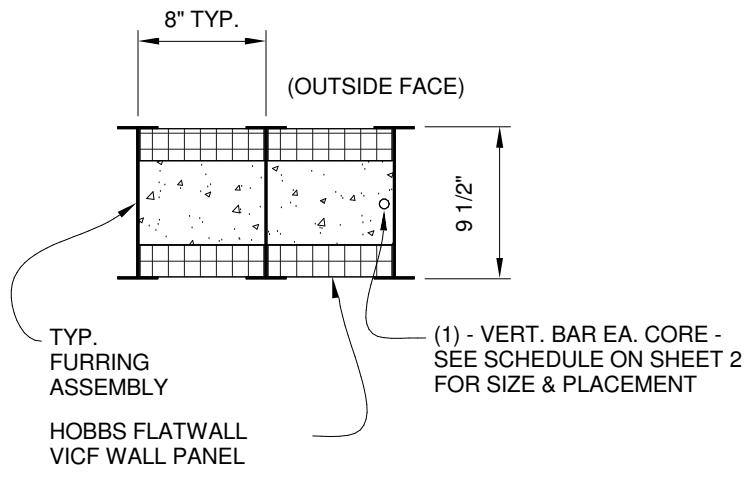

2 PLAN DETAILS  
1" = 1'-0"

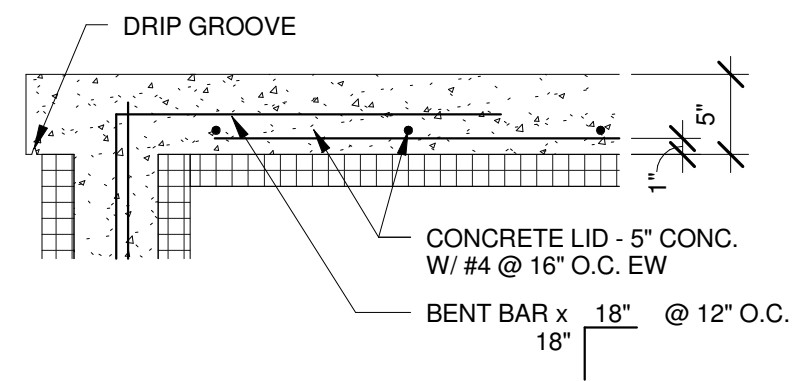

3 CONC. LID TO WALL CONNECTION @ EXT. STOOP WALL  
1" = 1'-0"

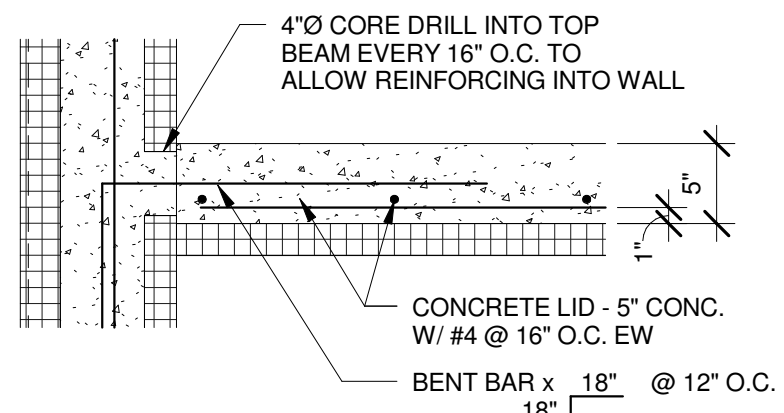
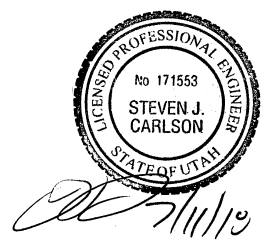

4 CONC. LID TO WALL CONNECTION @ STOOP  
1" = 1'-0"

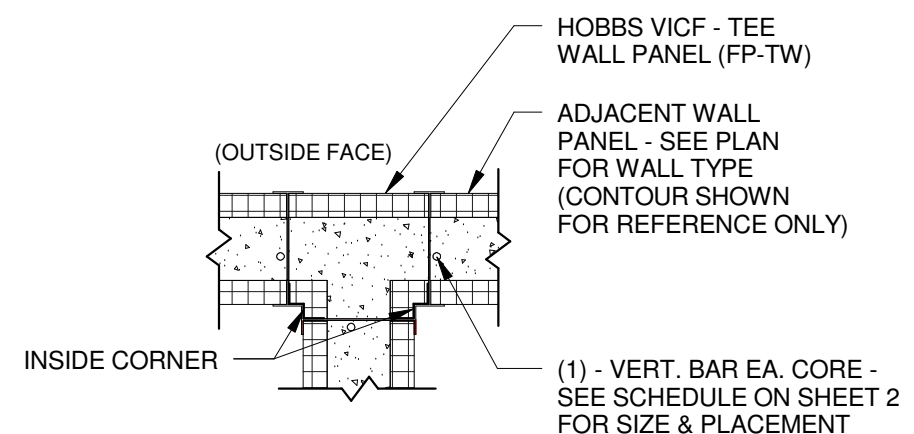

5 TEE WALL - EXPOSED STUD (E.S.)  
3/4" = 1'-0"

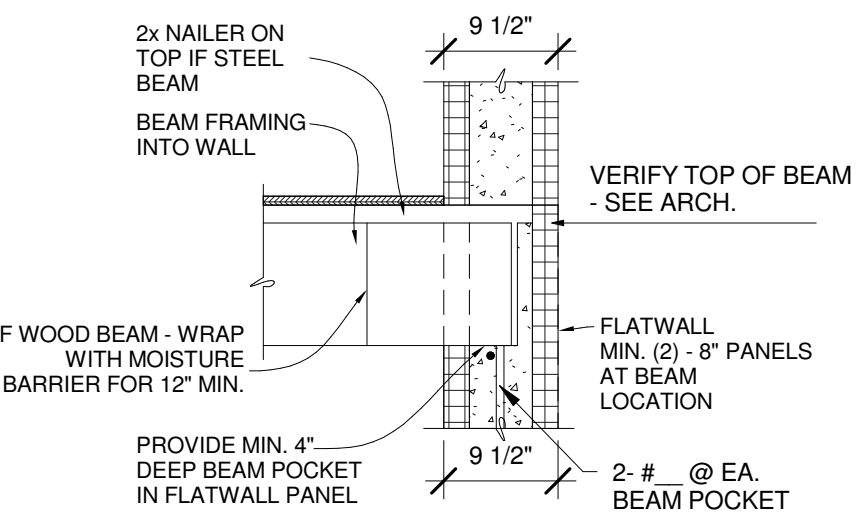
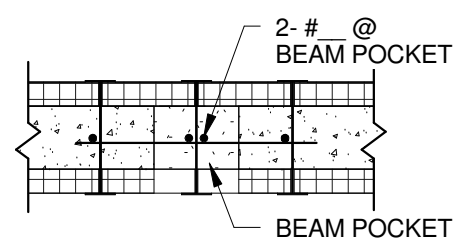

6 BEAM POCKET  
3/4" = 1'-0"

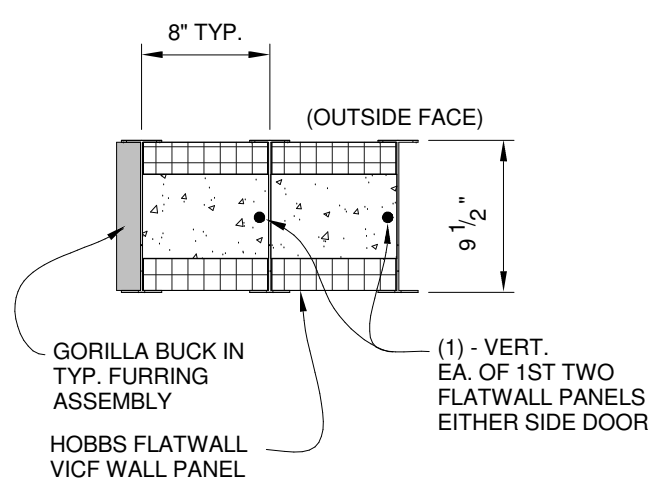

7 JAMB DETAIL  
1" = 1'-0"

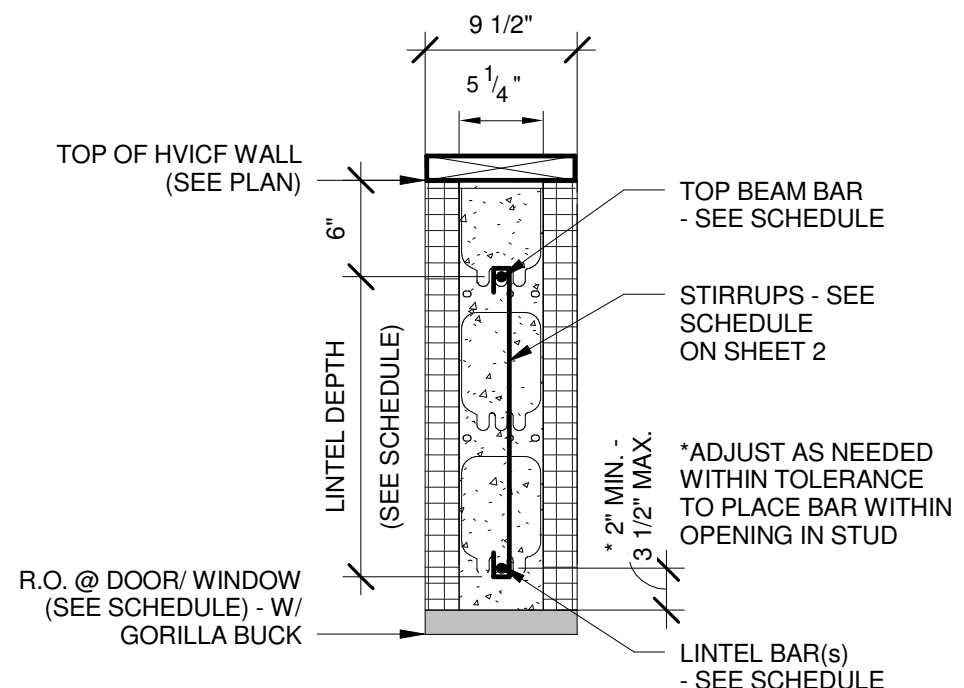

8 LINTEL DETAIL @ BASEMENT  
1" = 1'-0"

KAYSVILLE, UT 84037

JOB #: 182099

NOT FOR CONSTRUCTION  
 FOR CONSTRUCTION

ISSUE DATE :  
080818

REVISIONS:

1	6
2	7
3	8
4	9
5	10

DRAWING SCALE :  
As indicated  
DRAWING NAME :  
DETAILS

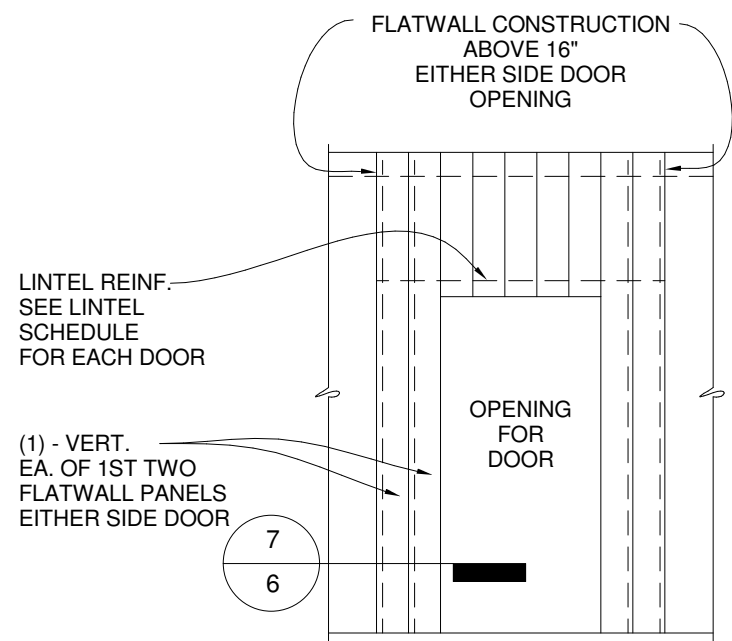

1 TYP. ELEV. @ DOOR  
1/4" = 1'-0"

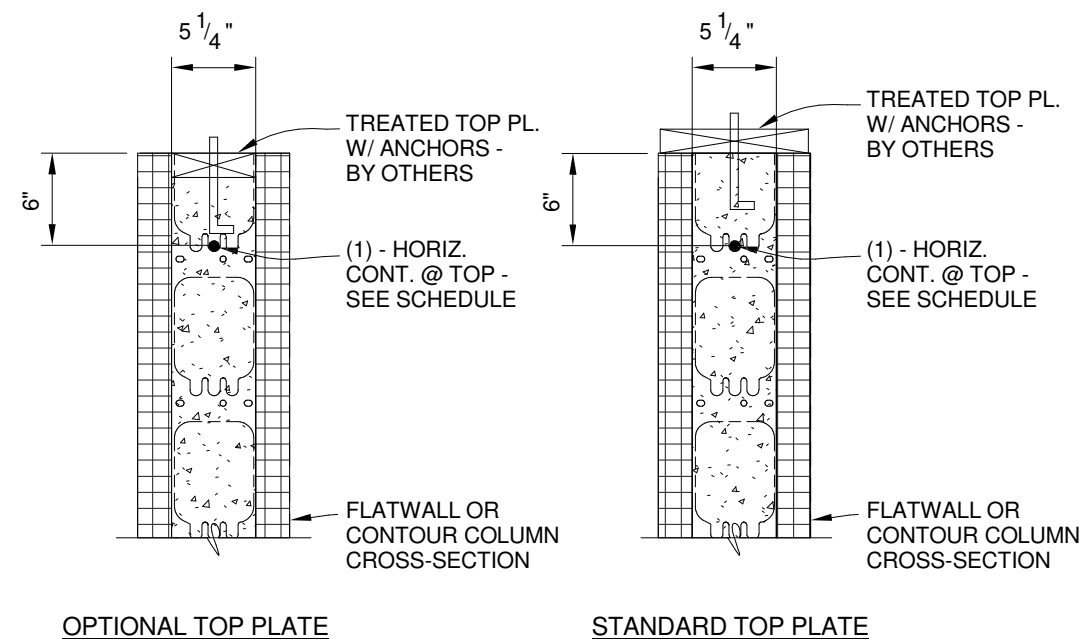

TOP PLATE NOTE: ONLY ONE TOP PLATE CONFIGURATION CAN BE USED

2 TOP OF WALL @ FLAT WALL  
1" = 1'-0"

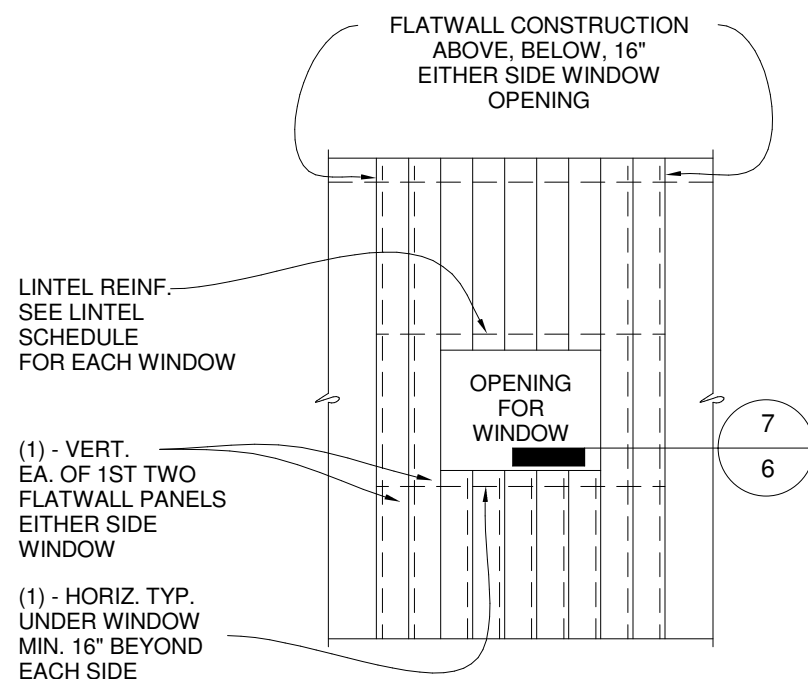

3 TYP. ELEV. @ WINDOW  
1/4" = 1'-0"

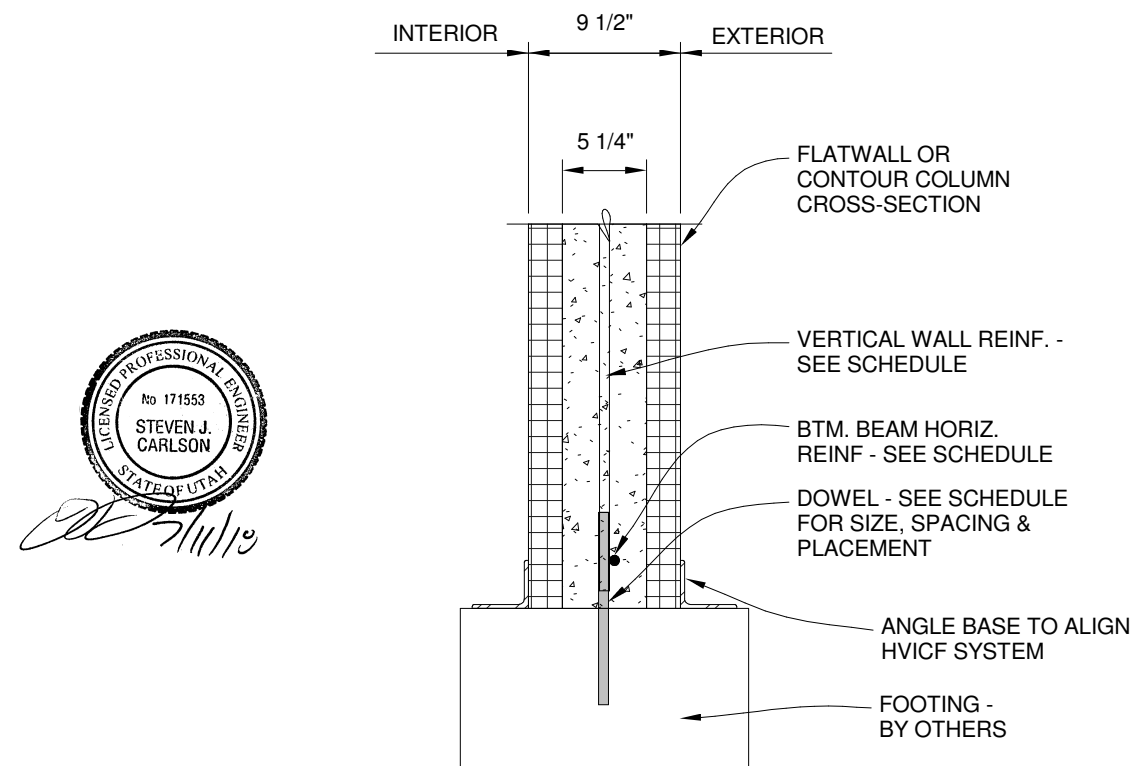

4 BOTTOM OF WALL @ FLAT WALL  
1" = 1'-0"

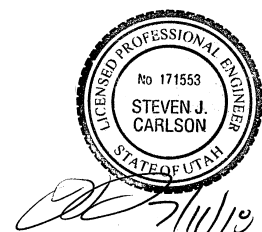

KAYSVILLE, UT 84037

JOB # : 182099

NOT FOR CONSTRUCTION

FOR CONSTRUCTION

ISSUE DATE :

080818

REVISIONS:

1	6
2	7
3	8
4	9
5	10

DRAWING SCALE :

As indicated

DRAWING NAME :

DETAILS

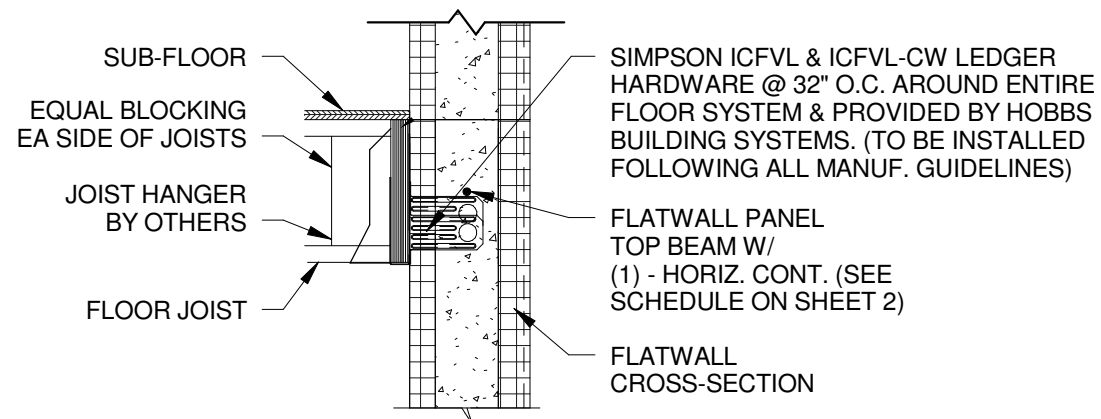

1 LEDGER BEAM - @ JOIST BEARING  
3/4" = 1'-0"

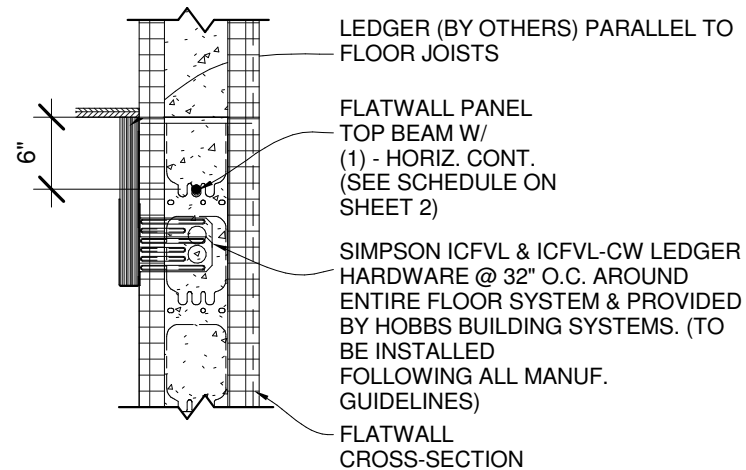

2 LEDGER BEAM - PARALLEL TO JOISTS  
3/4" = 1'-0"

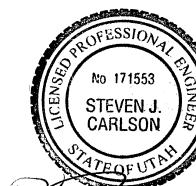

*Signature*

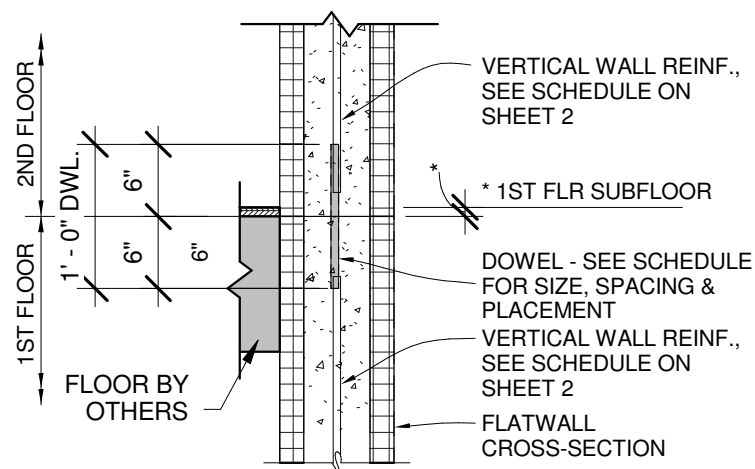

\* TOP OF WALL TO BE FLUSH WITH TOP OF FLOOR JOISTS

3 WALL CONNECTION - 1ST TO 2ND FLR  
3/4" = 1'-0"

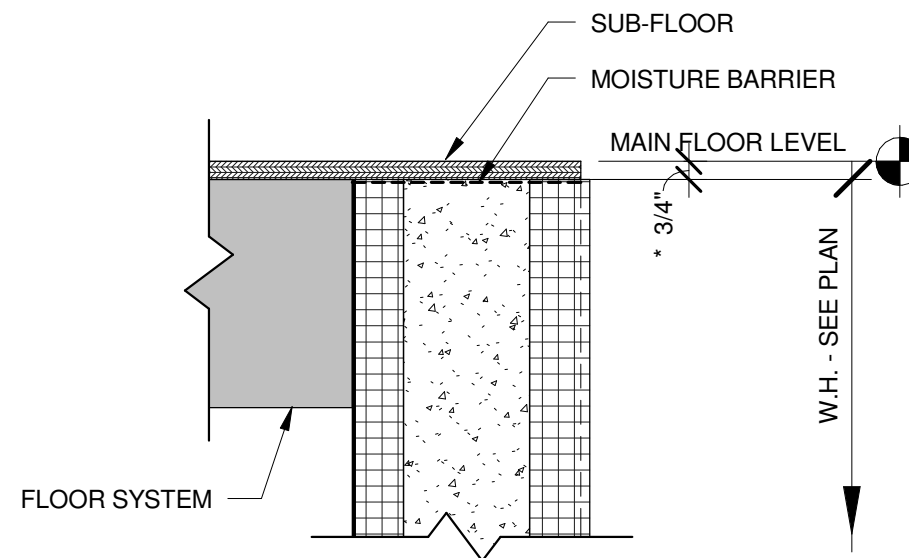

**SECTION**

**NOTES:**

- TOP OF HVICF WALL = TOP OF FLOOR JOISTS
- INSTALL MOISTURE BARRIER BETWEEN SUB-FLOOR AND TOP OF WALL
- FLOOR JOISTS TO BEAR ON LEDGER OR EMBEDDED JOIST HANGER
- \*CONTRACTOR IS RESPONSIBLE FOR DETERMINING FINISH FLOOR ELEVATION

4 DOOR SILL DETAIL  
1 1/2" = 1'-0"

KAYSVILLE, UT 84037

JOB # : 182099

- NOT FOR CONSTRUCTION  
 FOR CONSTRUCTION

ISSUE DATE :

080818

REVISIONS:

1	-	6
2		7
3		8
4		9
5		10

DRAWING SCALE :

As indicated

DRAWING NAME :

DETAILS



W.H. = 9' - 1 1/2" & 12' - 0" - SEE PLAN FOR W.H.

W.H. = 10' - 0"

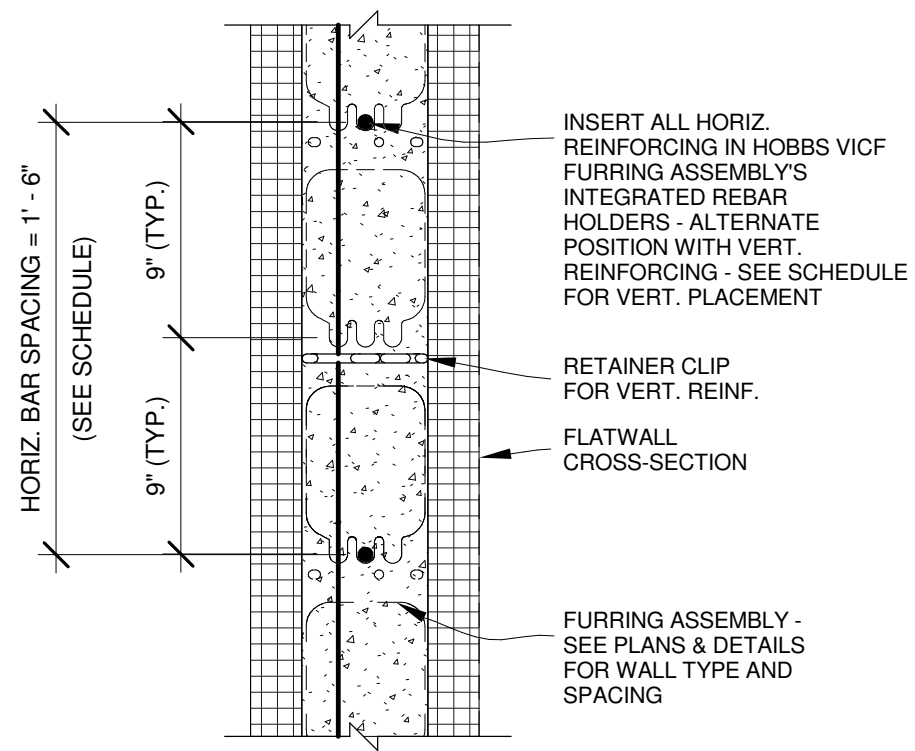
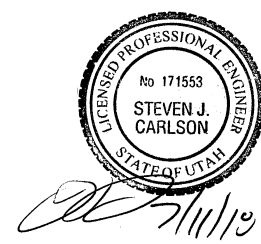
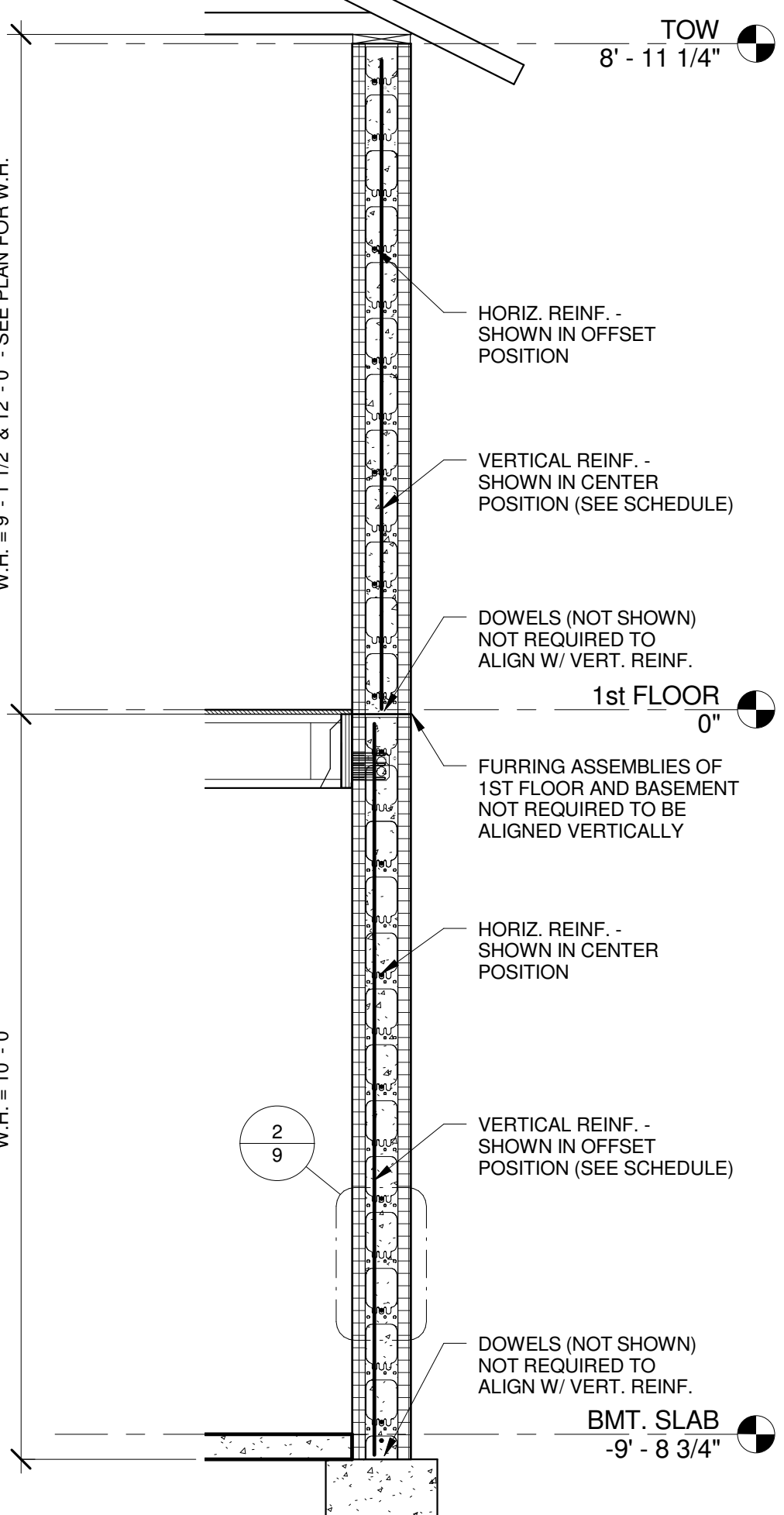

① TYP. HORIZ. REINF.  
1/2" = 1'-0"

② HORIZ. REBAR HOLDER  
1 1/2" = 1'-0"

KAYSVILLE, UT 84037

JOB # : 182099

- NOT FOR CONSTRUCTION
- FOR CONSTRUCTION

ISSUE DATE :  
080818

REVISIONS:

△ 1	-	△ 6
△ 2		△ 7
△ 3		△ 8
△ 4		△ 9
△ 5		△ 10

DRAWING SCALE :  
As indicated

DRAWING NAME :  
HORIZ. REINF.